

LRRC AUDITORIUM

The LRRC Auditorium features deluxe tiered seating for 109, a stage with two smart podium and excellent acoustics.

Location: first floor LRRC

Room arrangement: 6 rows with 16 seats and center aisle with additional seating along back wall

Dimensions: 26' x 44' (1,144 square feet)

Stage dimensions: 35' x 8' (280 square feet)

Capacity: 109 plus limited wheelchair space

Electronic capabilities

- Ten gigabit fiber optic high speed internet connection
- Dual 16:9 aspect ratio high definition video projectors and screen
- Two Instructor-controlled and presentation smart podiums equipped with built-in confidence monitor, resident PCs, inputs for visiting laptops and podium-wired microphones for quality sound
- Visual annotator on one smart podium
- Resident desktop computers in smart podiums with support for Microsoft Office, PDF, wired high-speed internet access, and projection system
- Two high definition robotic cameras and one digital document camera
- Lync and Skype-capable teleconferencing (single analog line for calling out to external host)
- Polycom-capable video teleconferencing with capable hosting to three outside peers (return audio from outside peers is routed through room's speaker system)
- DVD/Blu-Ray players
- Room LCD touch panel systems control
- Programmable lighting
- Four wireless microphones (three lavalier and one hand-held) are available for room use

Amenities

- Acoustically-sound room
- Lecture capture recording upon special request
- Deluxe seating with pullup desks
- Coat Rack and restrooms immediately outside room

Cost to rent

\$150 per hour

\$900 for the day

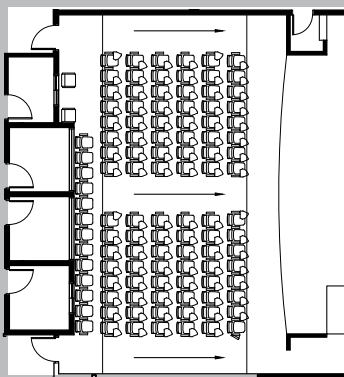

University of Illinois Fire Service Institute
Learning Resource and Research Center
11 Gerty Drive, Champaign IL 61820
217/333-3800

www.fsi.illinois.edu

For space rental information, call 217/333-4215 or email fsi-space@illinois.edu